

↑ NORTH

TENANT A

TENANT B

TENANT C

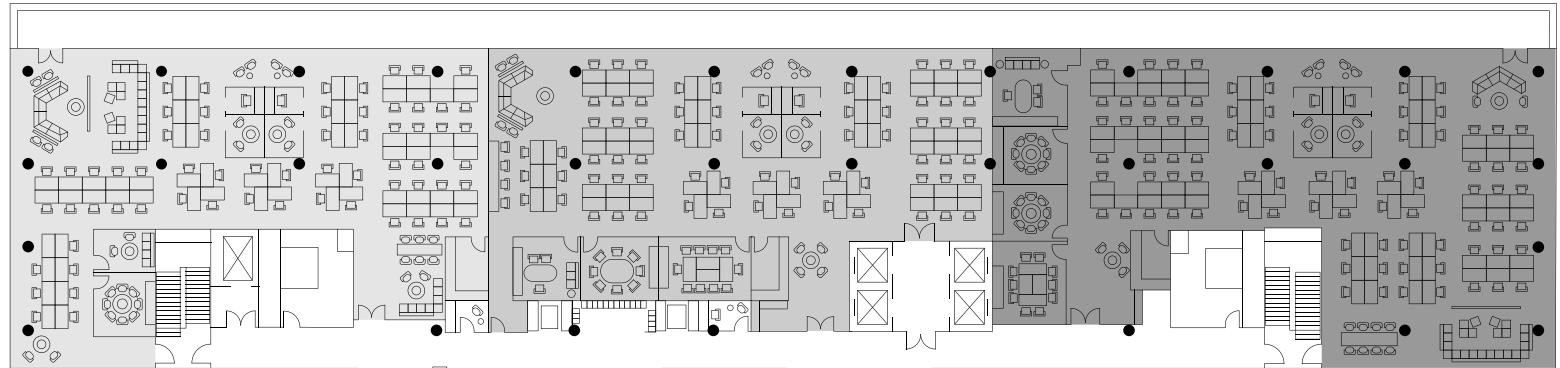

↓ WEST

EAST ↓

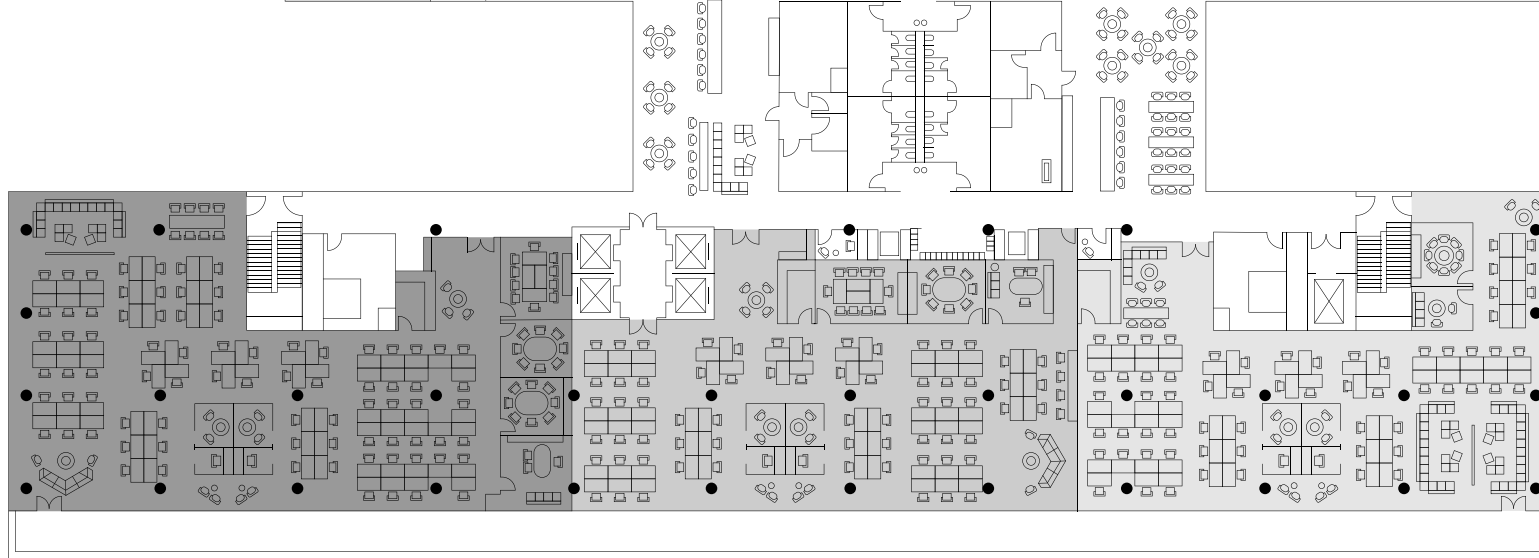

TENANT D

TENANT E

TENANT F

↓ SOUTH

25 KENT

25 Kent Avenue, Williamsburg Brooklyn, NY 11249

MULTI-TENANT FLOOR

Keeping it small or just getting started? A multi-tenant floor may be just right. Cross-pollinate in the shared communal space as you grow into your own.

- + TENANT A — 10,600 RSF, 85 EMPLOYEES
- + TENANT B — 8,772 RSF, 70 EMPLOYEES
- + TENANT C — 15,447 RSF, 124 EMPLOYEES
- + TENANT D — 13,871 RSF, 111 EMPLOYEES
- + TENANT E — 10,417 RSF, 83 EMPLOYEES
- + TENANT F — 10,628 RSF, 85 EMPLOYEES

TWENTYFIVEKENT.COM